

How To Measure A U-Bolt

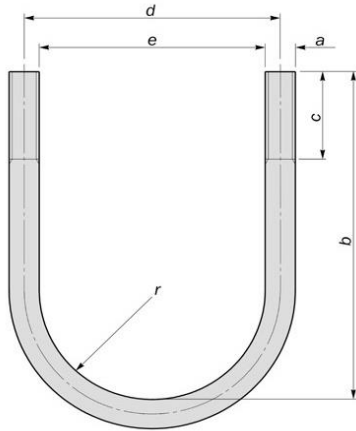

Nom Pipe Size	Pipe O.D	A	B	C	D	E	R
mm	mm	mm	mm	mm	mm	mm	mm
15	21.3	M8	46	25	30	22	11
20	26.9	M8	56	25	35	27	13.5
25	33.7	M8	61	25	45	37	18.5
32	42.4	M8	71	25	55	47	23.5
40	48.3	M10	85	35	60	50	25
50	60.3	M10	95	35	75	65	32.5
65	76.1	M12	124	45	90	78	39
80	88.9	M16	142	50	105	89	44.5
100	114.3	M16	167	50	135	119	59.5
125	139.7	M16	192	50	160	144	72
150	168.3	M20	225	55	190	170	85
175	193.7	M20	250	55	215	195	97.5
200	219.1	M20	285	55	245	225	112.5
225	244.5	M20	300	55	270	250	125
250	273.0	M20	340	60	300	280	140
300	323.9	M20	390	60	350	330	165
350	355.6	M24	428	65	385	361	180.5
400	406.4	M24	488	65	435	411	205.5
450	457.0	M24	528	70	485	461	230.5
500	508.0	M24	588	70	540	516	258
550	559.0	M24	638	70	590	566	283
600	610.0	M24	688	70	640	616	308

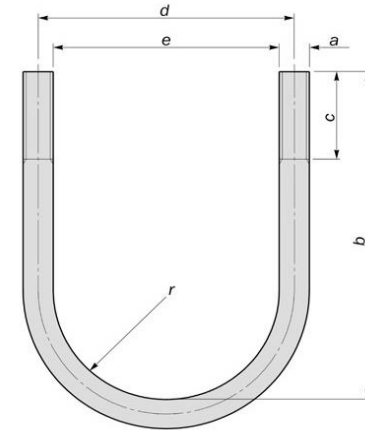

To Determine The Correct Size Of U-Bolt For Your Application

U Bolts Are Traditionally Used To Clamp Pipes Into Place
 Engineers Who Design Pipe Systems Are Wholly Concentrated On The
 Inside Of Tube - From There They Can Determine How Much Fluid OR Gas
 Can Flow Through The Pipe.

U-Bolts Are Requested By "Nominal Bore - Indside Diameter"

EG: British Standard Pipe With A 50m/m Bore

Will Have A 60.3m/m Outside Diameter

Material: Steel Zinc Plated - Steel Galvanised - Stainless Steel